

REVISIONS

REV	DESCRIPTION	DATE	DR

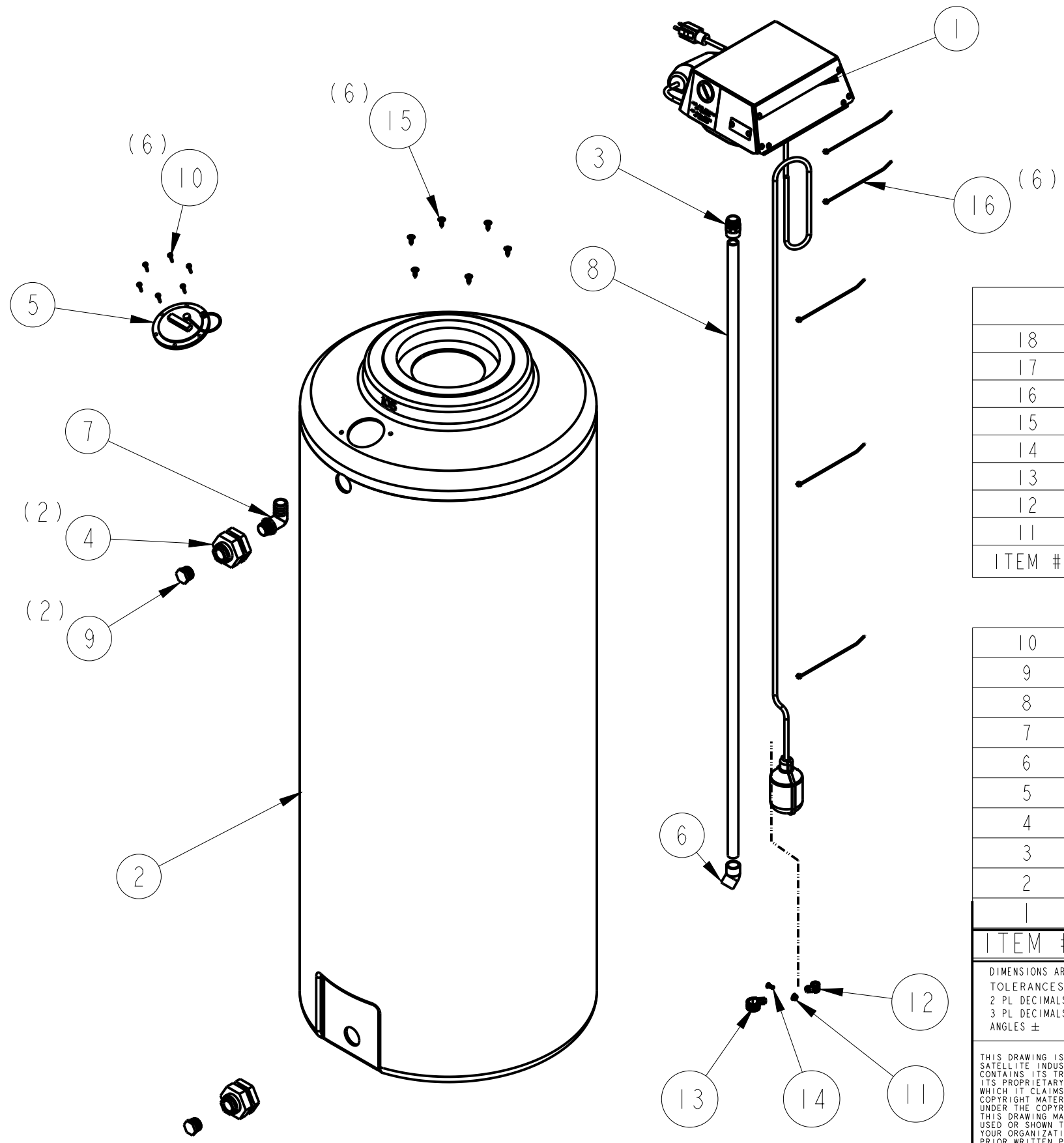

NOTE:
 1. ASSEMBLE PER INSTRUCTIONS
 2. ITEMS BAGGED TOGETHER UNDER COVER MUST BE RE-PLACED UNDER COVER AND COVER SECURED.

ITEMS 11 - 18 INCLUDED IN PN 25617 KIT- PUMP ASSEMBLY FWDS

ITEM #	PART #	QTY	DESCRIPTION
18	--	1	INSTRUCTIONS FLOJET PUMP AND FLOAT SWITCH
17	--	4	FITTINGS-FLOJET PUMP (PARTS SUPPLIED WITH PUMP)
16	11261	6	TIE WIRE- 8in"
15	25619	6	SCREW #12 X 3/4 TRUSS
14	21144	1	SCREW- 10-24 X 1/2 PHPN STNLS
13	25691	1	P-CLAMP- 3/4" ID INSULATED
12	25618	2	P-Clamp 3/8" ID INSULATED
11	25620	1	NUT- #10-24 NYLOC FLANGE

10	15513	6	SCREW- #8 X 3/4 TAP STNLS
9	24479	2	PLUG- 3/4 MPT MALE
8	22498	5.00'	PIPE- 1/2" PVC SCHED 40 - 10' (CUT TO 5.00')
7	1609-699	1	ELBOW- 3/4 MPT x 1 INSERT
6	25622	1	ELBOW- 1/2 x 45DEG SLIP PVC
5	7066-699	1	CAP- ASSY TWIST TAG2
4	1328-699	2	BULK HEAD FITTING- 3/4
3	24421	1	ADAPTER- 3/4 MPT x 1/2 SLIP PVC
2	25625	1	105 GALLON TANK (BLANK)
1	25617	1	KIT- PUMP ASSEMBLY FWDS

ITEM #	PART #	QTY	DESCRIPTION
--------	--------	-----	-------------

DIMENSIONS ARE IN INCHES [MM]
 TOLERANCES ON:
 2 PL DECIMALS ±
 3 PL DECIMALS ±
 ANGLES ±

THIS DRAWING IS THE PROPERTY OF SATELLITE INDUSTRIES, INC. AND CONTAINS ITS TRADE SECRETS AND ITS PROPRIETARY INFORMATION FOR WHICH IT CLAIMS UNPUBLISHED COPYRIGHT MATERIAL PROTECTION UNDER THE COPYRIGHT ACT OF 1976. THIS DRAWING MAY NOT BE COPIED OR USED OR SHOWN TO PARTIES OUTSIDE YOUR ORGANIZATION WITHOUT THE PRIOR WRITTEN PERMISSION OF SATELLITE INDUSTRIES, INC.

SIGNATURES	DATE
DRAWN	
CHECKED	
ENGRG	
MFG. ENG.	
QA. ENG.	

Satellite Industries, Inc.
 Minneapolis, MN 55441 U.S.A.

TITLE
 TANK ASSY- 105 GALLON FWDS
 DWG NO 25616
 REV A

