

HOLDING TANKS, CONTAINMENT TRAYS, & ACCESSORIES



GRAY - #22394 | NATURAL - #22395



#5250-00



GRAY - #24141 | NATURAL - #24140



#4008-602



#35616



#4903-599

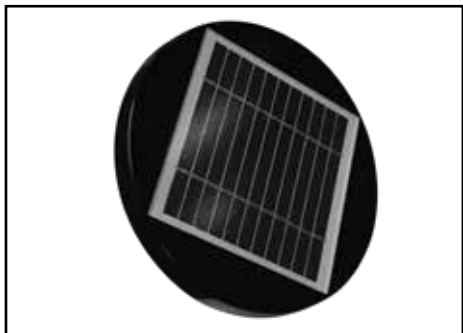

#10018



#22410



#23878



#10019



#14551



#1038-699

ITEM #	PART #	QPU	DESCRIPTION	COMMENT	PRICE
	14551		PADLOCK- 30MM SATELLITE		
	21764		KEY- PADLOCK 30MM SATELLITE		
	1038-699		PADLOCK- (55/25) W/ KEY (5253)		
	1050-699		KEY- (5253) FOR LOCK (55/25)		
	10019		SOLAR LIGHT- 5 LED		
	10018		SOLAR FAN- PORTABLE TOILET		

HOLDING TANKS, CONTAINMENT TRAYS, & ACCESSORIES

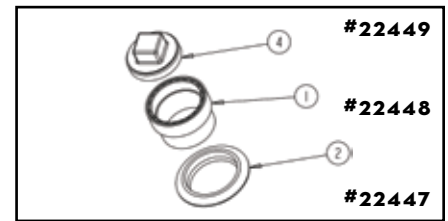
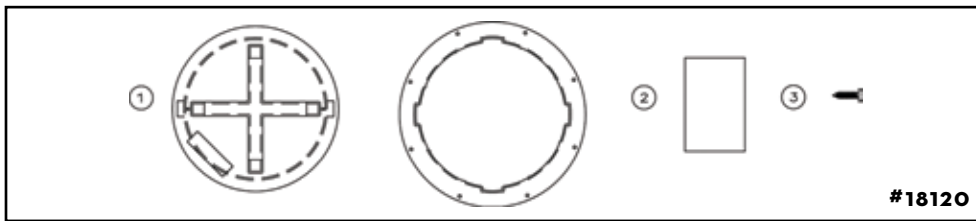

ITEM #	PART #	QPU	DESCRIPTION	COMMENT	PRICE
	1265-699		IN- LINE GFCI PLUG		
	1668-699		ADAPTER- 1/2 MP X 1/2 SLIP CPV		
	1331-699		BULK HEAD FITTING 1/2"		
	1261-699		CONDUIT BODY- 1/2 TYPE T		
	1262-699		CORD CONNECTOR 1/2" NPT NYLO		
	1264-699		CORD- FLOAT SWITCH CABLE FLOAT		
	1665-699		ELBOW- 1/2 MNPT X 1/2 BARB		
	1243-699		HOSE- CLEAR PVC REINFOR TUBING		
	1332-699		MOUNT- PUMP ISOLATOR		
	1674-699		NIPPLE- 1/2 MNPT X 1/2 MNPT		
	1607-699		PLUG- 1/2 THREADED		
	4907-699		PUMP- FLOJET 4300-0545A 115V		
	12393		RIVET- #64 AAP POP		
	1937-699		SCREW- 6 X 1/2 SS PH PAN H		
	1969-699		STEEL U-BOLT- 5/16-18 X 1		
	4903-599		TANK- 275 GAL FRSH WATER DELIV		
	25616		TANK ASSY- 105 GALLON FWDS		
	1713-699		WASHER- 1/4 STAINLESS FLAT		
	1711-699		WASHER- 5/16 LOCK WASHER SS		
	1717-699		WASHER- FLAT 5/16 X 0.625		
	22448		ADAPTER- 3 FPT X 3 SPIGOT PVC		
	18118		CAP/RING ASSY- 10IN PLS MANWAY		
	4008-602		CONTAINMENT SYSTEM- 250GL TANK		
	22447		GASKET- 3" UNISEAL ADAPTER		
	22394		HOLDING TANK- 300 GAL DGRY II		
	22395		HOLDING TANK- 300 GAL NAT II		
	18120		KIT- 10IN PLASTIC MANWAY		
	22477		KIT- 3" SPIGOT 250 GALLON TANK		
	22449		PLUG- 3IN MIPT PVC		
	10122		SCREW- #10 X 3/4 DHPN TAP PLTD		
	24141		TANK- 250GAL W/MANWAY 4004 GRY		
	24140		TANK- 250GAL W/MANWAY 4004 NAT		
	5250-00		TANK- HOLDING 250 GAL DGRY		
	22410		TRAY- CONTAINMENT II		
	23878		TRAY- TRAILER UNIT CONTAINMENT		