

TUFWAY II® POP RIVET

Portable Restroom Assembly Instructions

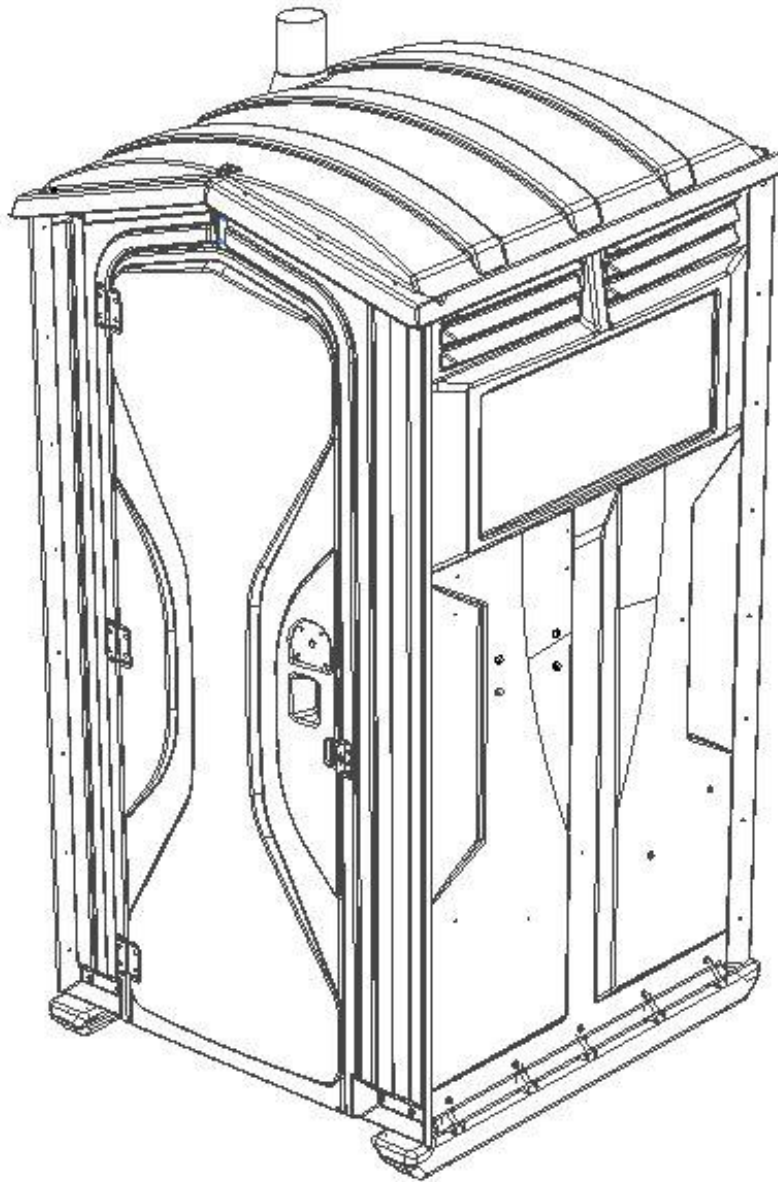

13705 1st Ave N, Plymouth, MN 55441
Telephone: 763-553-1900 Fax: 763-553-1905
800-328-3332 / www.satelliteindustries.com

INTRODUCTION

Instructions for the Tufway portable restroom

Satellite restrooms must be assembled according to approved assembly procedures. Avoid variations in assembly which could adversely affect product life.

The assembly procedures are written for assembly of single units. If assembling multiple units, considerable efficiency can be gained by working in assembly line fashion.

IMPORTANT: *Do not remove shipping strap from bottom of door until instructed in the “Install the Front Assembly” step.*



TOOLS

- RIVET GUN
- DRILL ELEC/CORDLESS
- 3/8 NUT DRIVER BIT
- 1/4 DRILL BIT
- DEBURRING TOOL
- #2 PHILLIPS SCREWDRIVER OR DRIVER BIT
- APRONS (CARPENTERS)

HELPFUL HINTS

- Have an apron with at least two large pockets that allow the parts to be remove easily.
- Don't open up all your kit boxes. Open up only enough kit boxes to assemble the number of toilets you are currently working on. **KEEP PARTS ORGANIZED.**
- Use toilet paper holders for parts bins on multiple unit assembly
- The door latch can be put on at any time. It may be more efficient to have someone do this early on multiple unit assembly.

EXPLODED UNIT ASSEMBLY

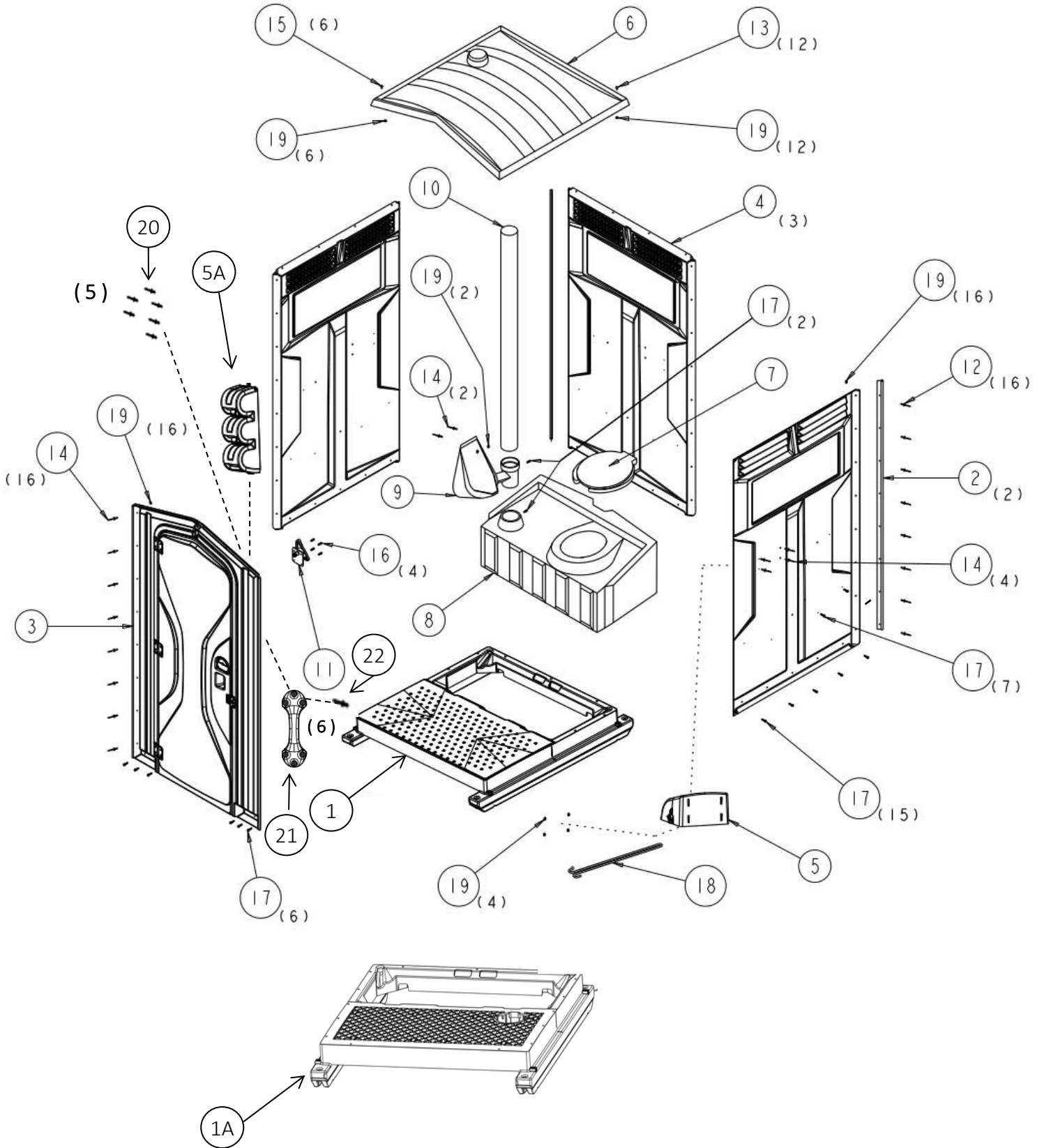

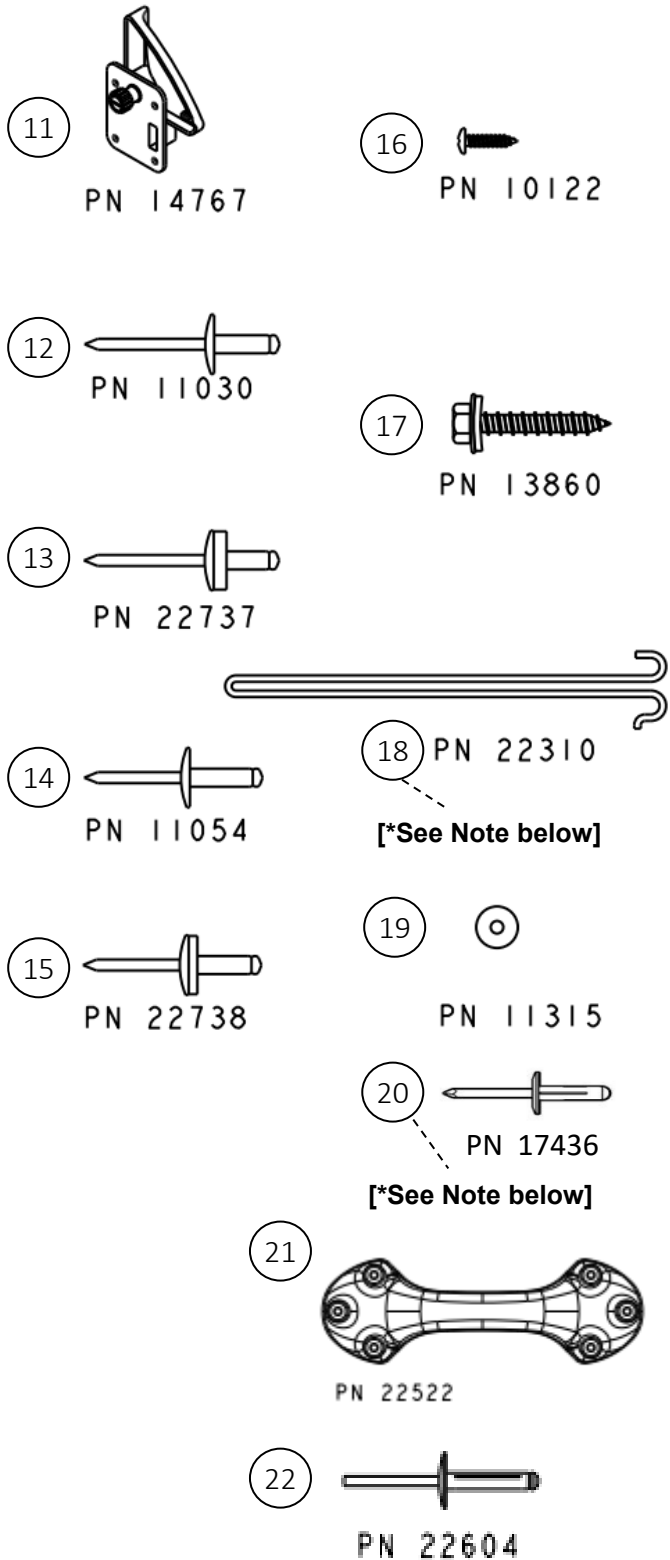

20	*17436	5	RIVET- AVDEL SILVER
18	*22310	1	SPINDLE- PRGRD II 3 ROLL METAL

*HDWE- TUFWAY II POP RIVET 27272			
22	22604	6	RIVET- TRI-LOBE X 5/8 LF
21	22522	1	HANDLE- PLASTIC LIFT DGRY
19	11315	56	WASHER- 3/16" RIVET STNLS
17	13860	30	SCREW, #14 X 1-1/2 W/WSH GOLD
16	10122	4	SCREW, #10 X 3/4 PN PH TAP
15	22738	6	RIVET, #68 POP W/RUBBER WASHER
14	11054	22	RIVET, #68 AAL POP
13	22737	12	RIVET, #66 POP W/RUBBER WASHER
12	11030	16	RIVET, #66 AAL POP
11	14767	1	LATCH, RESTROOM PLASTIC

STANDARD TUFWAY			
10	14133	1	VENT PIPE. 4 X 62-1/2 GREY
9	14119	1	URINAL, STAND OVER DGRY
8	10553	1	TANK, TUFWAY DGRY
7	10570	1	SEAT, TOILET
6	16045	1	ROOF, TUFWAY DOME
5A	25573	1	DISPENSER-T/P VERT 3 ROLL BLK
5	22209	1	HOOD- PAPERGRD 3 ROLL DGRY
*	27272	1	HDWE- TUFWAY II POP RIVET
4	15450	3	DESIGN, TUFWAY PANEL
3	27109	1	DESIGN, TUFWAY II FRONT ASSY
2	16050	2	CORNER MOLDING II BLACK PUNCH
1A	10033	1	BASE ASSY- IMPACT GRID FLOOR
1	10034	1	BASE ASSY- IMPACT SOLID FLOOR
ITEM	PART#	QTY	DESCRIPTION

***22310 Spindle is not in Hardware kit (used with 3 Roll 22209 T/P dispenser) is added to restroom BOM.
 *17436 Rivet is not in Hardware kit (used with 3 Roll 25573 T/P dispenser) is added to restroom BOM.**

DIRECTIONS

1. JOIN PANELS TOGETHER WITH CORNER MOLDING

SUPPORT THE REAR PANEL WITH A BOX AT LEAST 40" TALL BUT NOT WIDER THAN 41".
INSTALL RIVETS (PN 11030) FROM REAR PANEL WITH WASHER (PN 11315) ON THE SIDE
PANEL. IF ASSEMBLING SINGLE UNITS, USE THE WASTE TANK ON END.

NOTE: RECOMMEND, START WITH MIDDLE HOLE OF EACH CORNER & WORK TO ENDS OF
PANELS. MAKE SURE PANEL EDGES ARE FLAT AGAINST EACH OTHER & THERE ISN'T A GAP
IN PANELS BETWEEN RIVETS BEFORE SETTING RIVETS. ONLY IF THERE IS A GAP DRILL
PANEL HOLES USING 1/4" DRILL BIT TO OPEN HOLES SLIGHTLY LARGER "BE CAREFUL NOT
TO DRILL TO LARGE" & PANELS ARE FLAT AGAINST EACH OTHER BEFORE SETTING RIVETS.

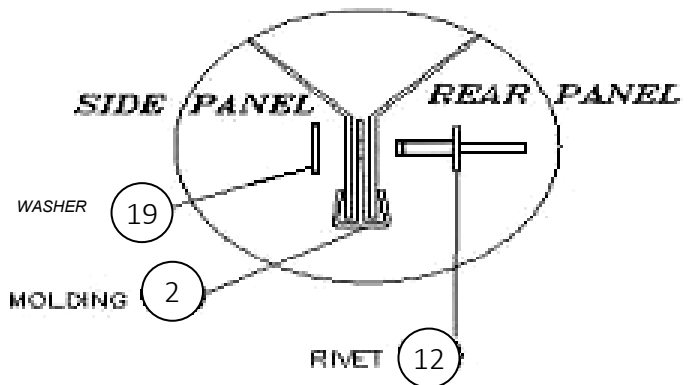
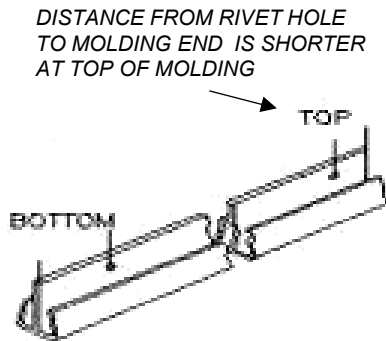
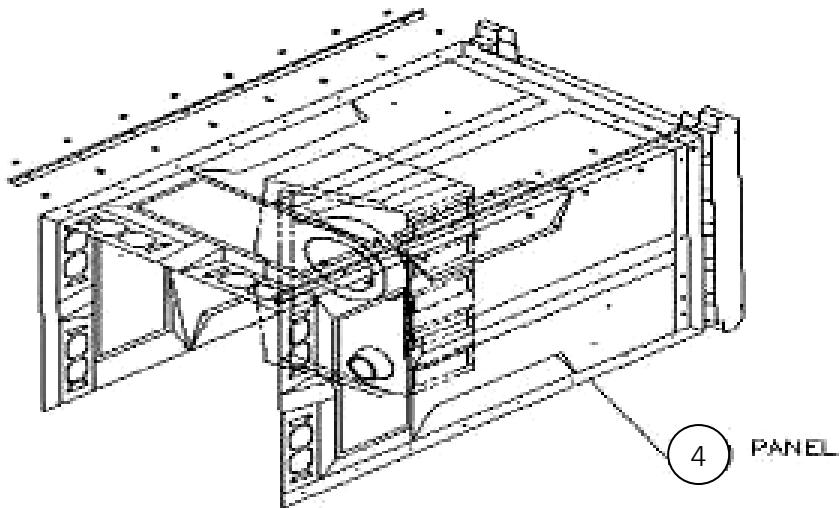

2. ATTACH BASE TO PANELS

TIP BASE UP AND POSITION INSIDE PANELS. USING THE DRILL AND 3/8" HEX DRIVER BIT. FASTEN PANELS TO BASE WITH LAG SCREWS (PN 13860)

IMPACT BASES: FASTEN REAR PANEL FIRST. USE THE CENTERING BUMP ON THE BASE TO CENTER THE PANEL THEN FASTEN THE REAR PANEL WITH LAG SCREWS. ** REPEAT PROCESS ON SIDE PANELS, USE THE CENTERING BUMPS TO CENTER PANELS AND INSTALL REMAINING SCREWS (see below).

**** NOTE: SIDE PANELS MUST BE FLUSH WITH SPACING RIBS AT EACH CORNER.**

IMPACT BASES

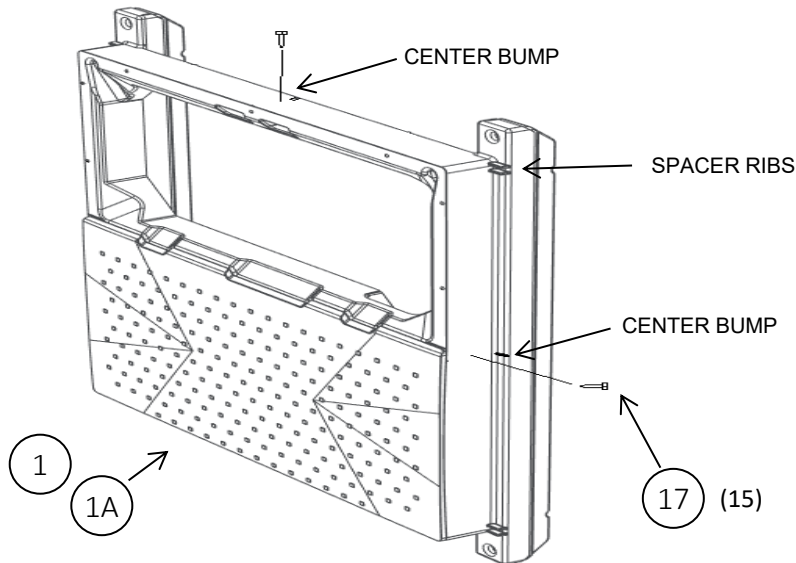

3. ATTACH ROOF TO PANELS

TILT ROOF UP AND POSITION OVER PANELS. INSTALL ALL RIVETS (PN 22737) AND WASHERS (PN 11315)

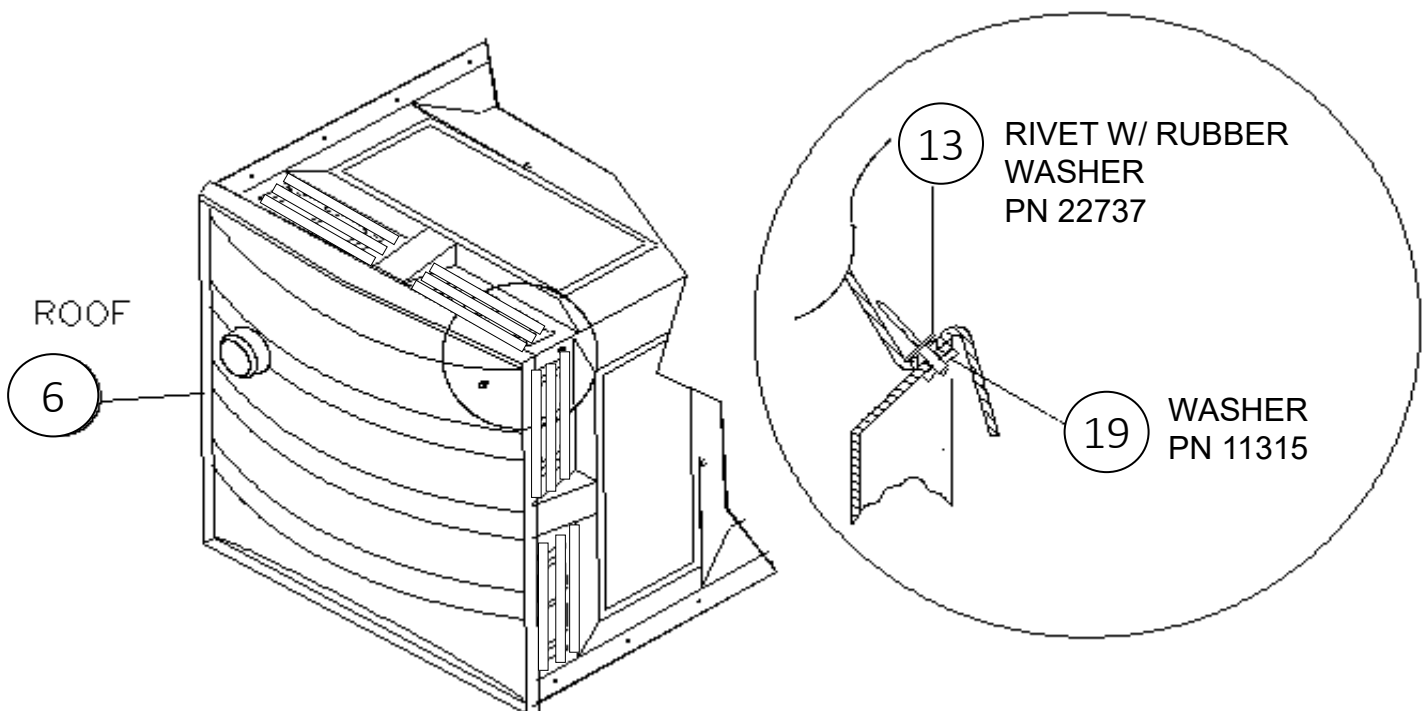

STAND UNIT UP ON BASE FOR THE NEXT ASSEMBLY STEPS

4. PLACE TANK IN UNIT

THE TANK MUST BE SEATED PROPERLY WHILE ATTACHING THE SIDE PANELS, HAVE A PERSON STAND IN TANK WHILE LAGGING PANELS TO TANK. USE 3/8" NUT DRIVER BIT & TIGHTEN SCREWS UNTIL RUBBER WASHER BEGINS TO FLATTEN .
DO NOT TO OVER TIGHTEN SCREWS.

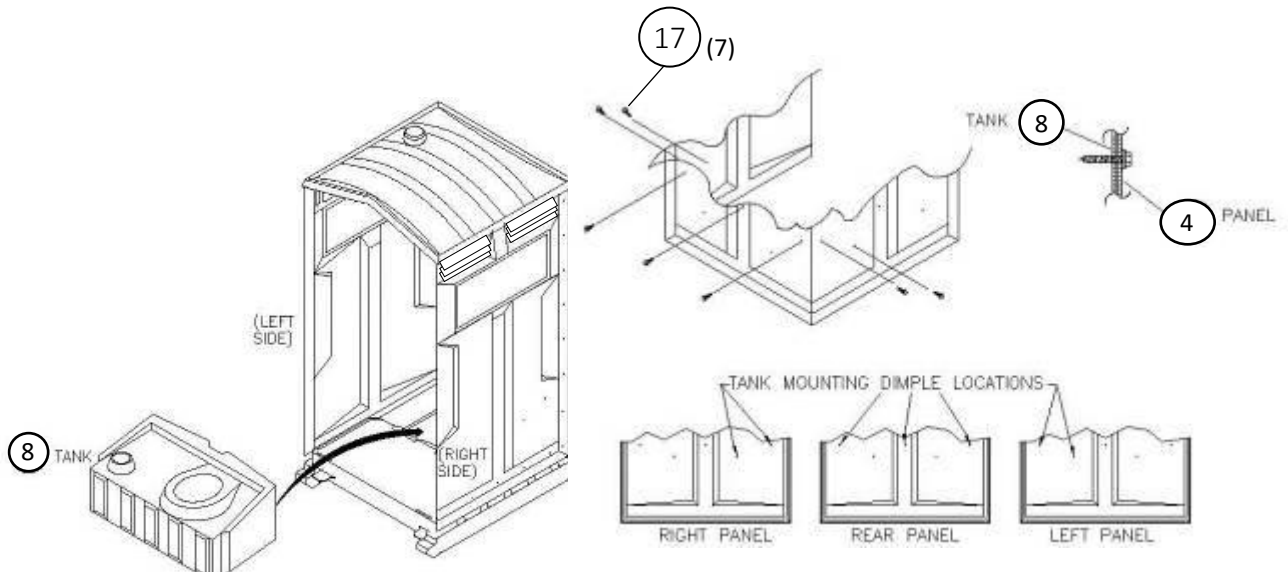

5. INSTALL URINAL

INSERT URINAL VENT PIPE INTO TANK VENT. LEVEL TOP EDGE OF URINAL. TRANSFER DRILL THROUGH URINAL HOLES INTO PANEL, WHILE HOLDING URINAL LEVEL. INSTALL RIVETS AND WASHERS

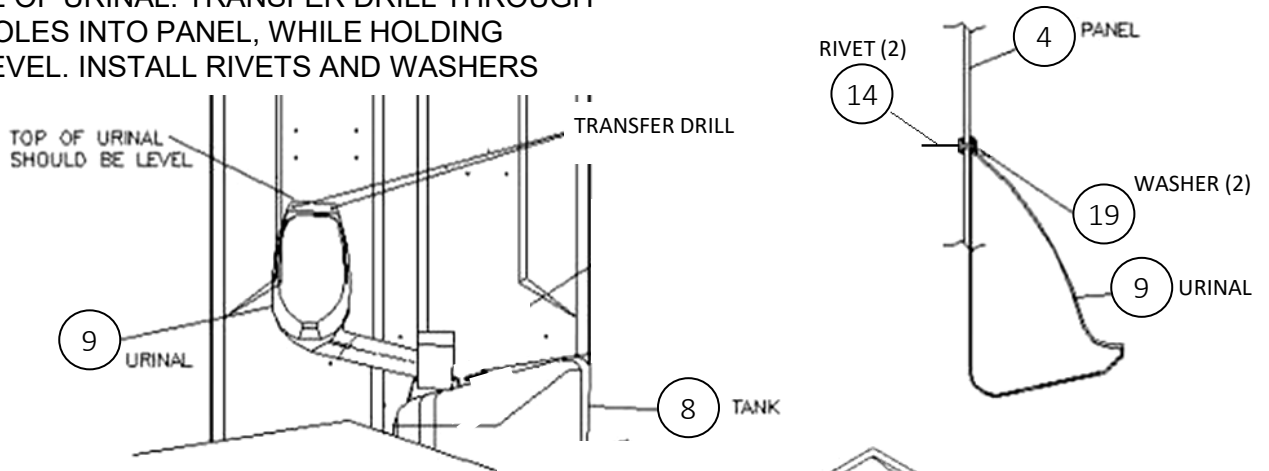

6. INSTALL VENT PIPE

INSERT VENT PIPE INTO ROOF HOLE, TWISTING PIPE MAY HELP. INSERT VENT PIPE INTO URINAL & INSTALL SCREWS.

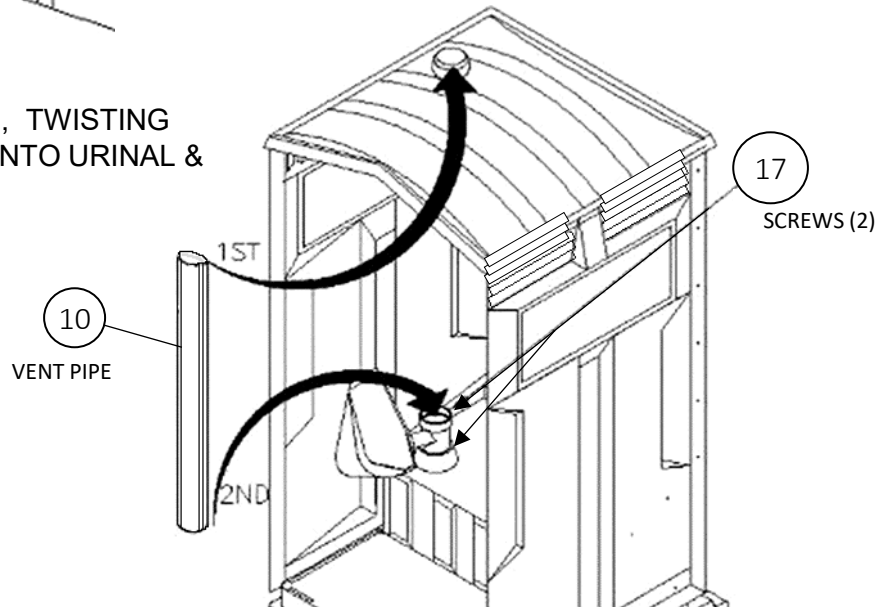

7. INSTALL 3 ROLL PAPERGUARD HOOD (22209)

DRILL (4) 1/4" HOLES AT DIMPLES ON RIGHT SIDE PANEL. INSTALL PAPERGUARD USING (4) RIVETS & (4) WASHERS. **NOTE: IF INSTALLING OTHER ACCESSORIES SUCH AS A SLIMMATE SINK, THE PAPERGUARD MUST BE PLACED IN A DIFFERENT LOCATION.**

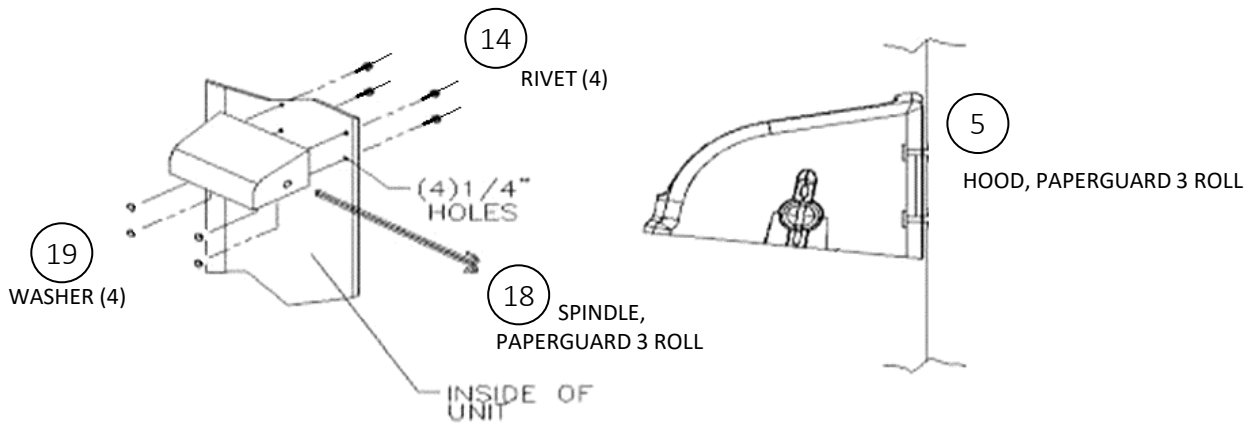

8. ATTACH TOILET SEAT

USE A SCREWDIVER. (TIGHTEN SEAT HINGE NUT SECURELY)

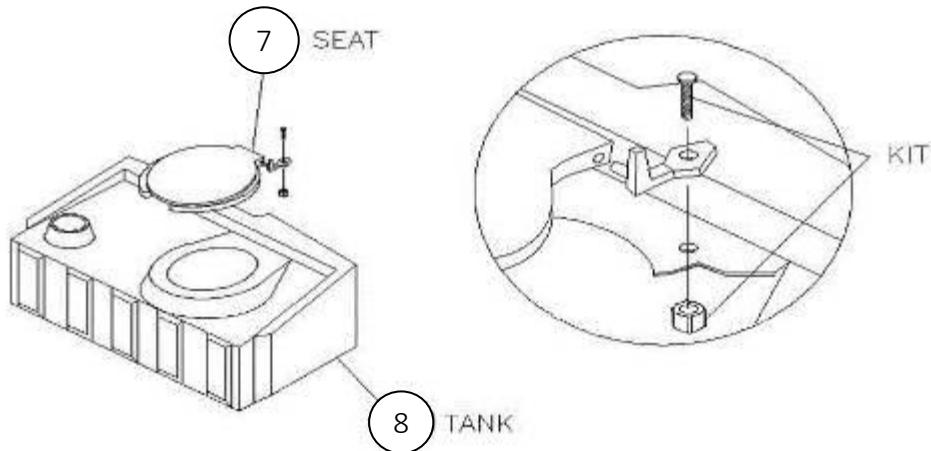

9. ATTACH FRONT ASSEMBLY TO ROOF (FOR THIS PROCESS LAY THE UNIT ON ITS BACK. INSTALL RIVETS AND WASHERS.

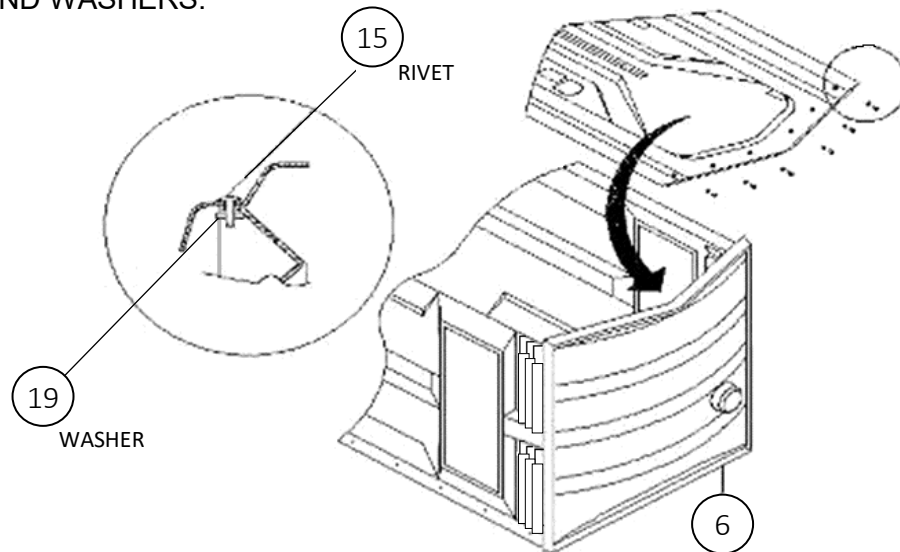

10. ATTACH FRONT ASSEMBLY TO SIDE PANELS

INSTALL RIVETS AND WASHERS **NOTE: RECOMMEND STARTING IN MIDDLE HOLE IN EACH CORNER & WORK TO ENDS OF FRONT / PANEL. MAKE SURE PANEL EDGE IS FLAT AGAINST FRONT & THAT THERE ISN'T A GAP IN FRONT / PANEL INBETWEEN RIVETS BEFORE SETTING RIVETS. ONLY IF THERE IS A GAP DRILL FRONT / PANEL HOLES USING 1/4" DRILL BIT TO OPEN HOLES SLIGHTLY LARGER "BE CAREFUL NOT TO DRILL TO LARGE" & FRONT / PANEL ARE FLAT AGAINST EACH OTHER BEFORE SETTING RIVETS.**

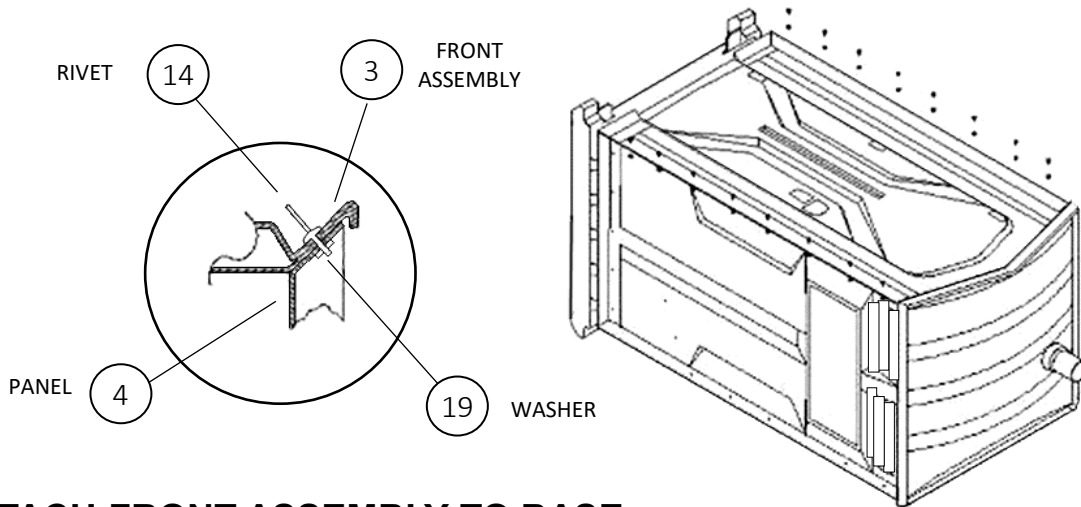

11. ATTACH FRONT ASSEMBLY TO BASE

1 & 1A. IMPACT BASES:

INSTALL SCREWS 13860 (4) USING A 3/8 NUT DRIVER BIT. REMOVE SHIPPING STRAP AT BOTTOM OF DOOR / FACING WITH PHILLIPS SCREWDRIVER OR DRIVER BIT. OPEN DOOR AND INSTALL THE (2) SCREWS THROUGH DIMPLES ON INSIDE OF FACING FRAME. TIGHTEN SCREW UNTIL RUBBER WASHER BEGINS TO FLATTEN - **DO NOT OVER TIGHEN .**

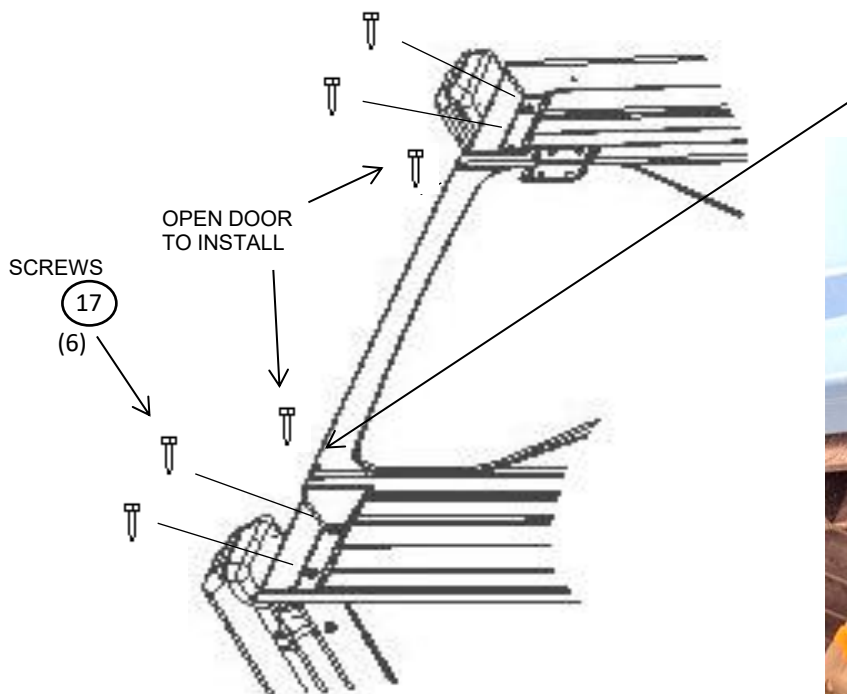

REMOVE 4 SCREWS IN SHIPPING STRAP



12. INSTALL DOOR LATCH

USE PHILLIPS SCREWDRIVER TO INSTALL (4) #10 SCREWS THROUGH LATCH IN DOOR ASSY.

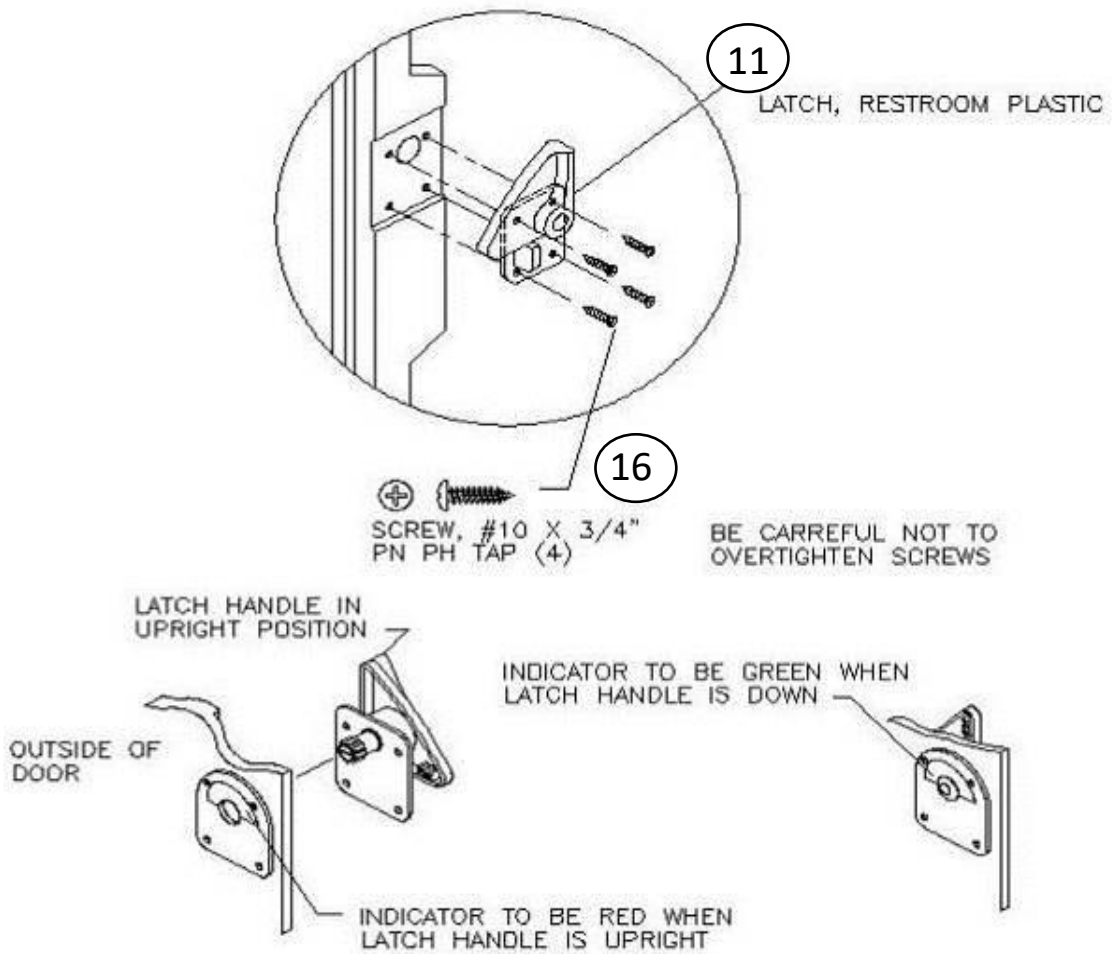

13. INSTALL DOOR HANDLE (on inside of door) INSTALL 6 RIVETS THROUGH TOP & BOTTOM HOLES IN HANDLE INTO PRE-DRILLED HOLES ON INSIDE OF DOOR.

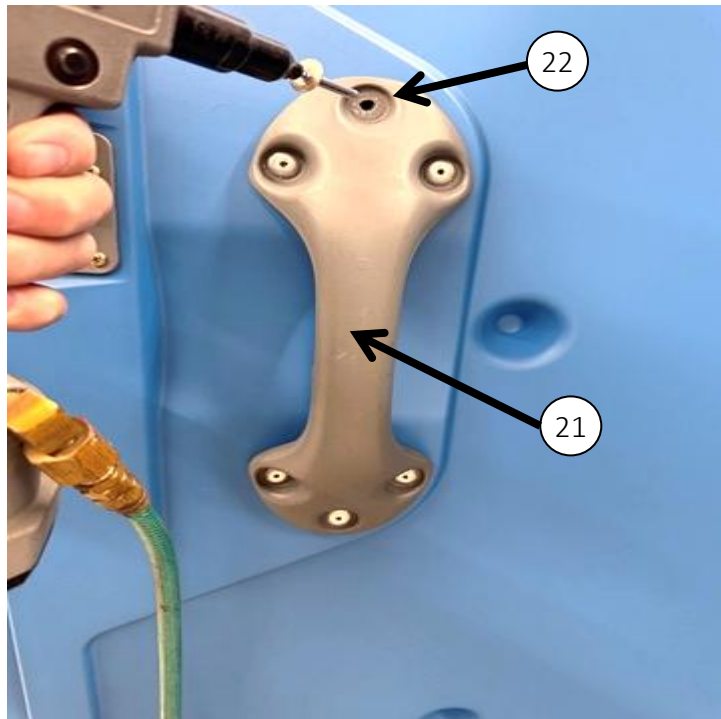

14. INSTALL 3 ROLL VERTICAL T/P DISPENSER (25573)



MARK ON INSIDE OF RIGHT FACING (HASP SIDE) UP 65" FROM FLOOR & OVER 4" FROM RIGHT PANEL (IN PROCESS OF ADDING DIMPLE [DRILL POINT] AT THIS LOCATION) ON FRONTS. DRILL AT MARK OR DIMPLE [DRILL POINT] USING #10 DRILL BIT (**THROUGH INSIDE WALL OF FACING ONLY**). FASTEN TOP TAB OF DISPENSER TO FACING IN HOLE DRILLED WITH #17436 RIVET. OPEN COVER & TRANSFER DRILL THROUGH 2 UPPER HOLES (FAR LEFT & FAR RIGHT HOLES). THEN DRILL 2 LOWER HOLES ON THE RIGHT AND LEFT SIDE OF DISPENSER BACKPLATE AS SHOWN AND FASTEN WITH (4) #17436 RIVETS.

4 Rivet locations inside on backplate

